



THAI TSUZUKI

THAI TSUZUKI CO.,LTD.

About Us

Introduction
History
Business Principle
Products
Technology



Company outline

Company name : Thai Tsuzuki Co., Ltd.
Established : 28, Feb. 2011
Start Operation : 12, Dec. 2011
Capital : JPY 700 million
(TSUZUKI Mfg. 100%)
Sales : JPY 2.0 Billion (2017)
President : Takayuki Yokoyama
Employee : 160 (Aug. 2018)
Location : Amata-City Chonburi

History

2011-Feb.	Established the Company
2011-Nov.	The 1st factory construction completed
2011-Dec.	Komatsu Implement PPC Valve
2012-Dec.	ISO 9001 & 14001 Certificated
2013-Feb.	Komatsu Travelling PPC Valve
2013-Sept.	Komatsu Piston & Valve
2013-Dec.	Honda Plate Pivot
2014-Oct.	HINO Mission Case
2015-Aug.	ISUZU Flywheel
2016-Nov.	HINO 230 Project
2018-Jan.	Compressor Bearing
2019-Mar.	Front Knuckle Honda Accord - Lower arm Honda Accord
2019-Jul.	Engine Part HINO
2019-Jul.	Shackle Front HINO
2019-Sep.	E-POC VALVE KOMATSU
2019-Sep.	Bearing Cap HONDA City

BUSINESS PRINCIPLE



Mr. Takayuki Yokoyama President's message

Business principle Our business principle has allured from our inspiration of harmonizing multi-cultural workplace and integrating wisdom and know-how to become united TTC Community

To contribute wisdom, know-how and production technology developed in japan and to create, cultivate and develop a successful business to the local community.

Machining

Overall Layout

Construction completed on 31 October 2011

View & Space

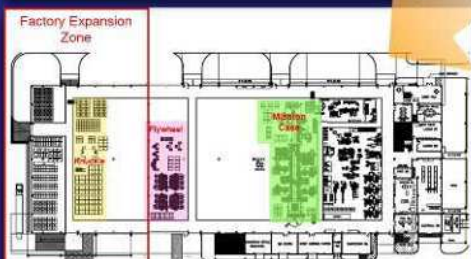

First Factory : 100m x 50m = 5,000 m²

Expansion Zone : 40m x 50m = 2,000 m² (Completed in June-2015)

The rest area can build
3 more factories.

Machining



TTC 工場内 (Inside of TTC)

測定室 Inspection Room

粗さ形状測定器 (Roughness & Contour)



3次元測定器 (3D Measuring Machine)



真円度測定器 (Roundness Test RA2000)



Main products

Timeline of Products



Product of year 2019



FRONT LOWER ARM
- KD610-T6



FRONT KNUCKLE
- FCD480



ENGINE BRACKET
-FCD450
-FCD500
-FCDA1



BEARING CAP
- FCD450

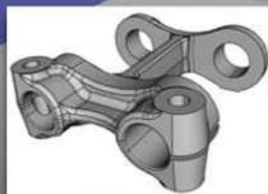
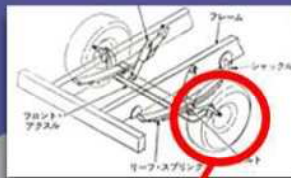

"Quality Assurance"



ISO 14001 : 2015



IATF 16949 : 2016



ISO 9001 : 2015

We applied ISO9001 & 14001 :
2015 version in 2018Y .

We applied IATF16949 :
2016 version in 2018Y.

THAI TSUZUKI CO.,LTD.

700/603 Moo 7, Don Hua Roh,
Muang Chonburi, Chonburi 20000

Tel: (66) 38 047 071

Fax: (66) 38 047 076

www.thai-tsuzuki.co.th

E-mail: recruit@thai-tsuzuki.co.th

 **Thai Tsuzuki**
บริษัท ไทย ทสึซูกิ จำกัด

